

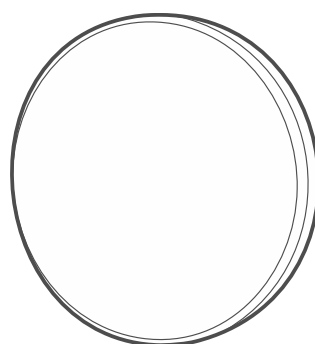

Smart Button
APB-210

Firmware version 1.01

EN



apb-210_BW_en 01/26

IMPORTANT

Changes, modifications or repairs not authorized by the manufacturer shall void your rights under the warranty.

Description of symbols on the device:



The device meets the requirements of the applicable EU directives.



The device must not be disposed of with other municipal waste. It should be disposed of in accordance with the existing rules for environment protection (the device was placed on the market after 13 August 2005).



The device is designed for indoor installation.

SATEL aims to continually improve the quality of its products, which may result in changes in their technical specifications and software. Current information about the changes being introduced is available on our website.

Please visit us at:
<https://support.satel.pl>

Hereby, SATEL sp. z o.o. declares that the radio equipment type APB-210 is in compliance with Directive 2014/53/EU. The full text of the EU declaration of conformity is available at the following internet address: www.satel.pl/ce

Signs in this manual



Caution – information on the safety of users, devices, etc.



Note – suggestion or additional information.

CONTENTS

1. Features	2
2. Installation	2
2.1 Tips for installation	2
2.2 Mounting	3
3. Battery replacement	3
4. Specifications	3

The APB-210 button (Smart Button) is used to control the system. The manual applies to the button installed in the BE WAVE system.

1. Features

- Signal sent after:
 - single push,
 - double push,
 - triple push,
 - long hold.
- Operation in the 868 MHz frequency band.
- AES encrypted two-way radio communication.
- Transmission channel diversity – 4 channels for automatic selection of the one that will enable transmission without interference with other signals.
- Remote settings programming.
- Remote firmware update.
- Powered by CR2032 3 V battery.
- Battery status control.

2. Installation



There is a danger of battery explosion when using a different battery than recommended by the manufacturer, or handling the battery improperly.

Do not crush the battery, cut it or expose it to high temperatures (throw it into the fire, put it in the oven, etc.).

Do not expose the battery to very low pressure due to the risk of battery explosion or leakage of flammable liquid or gas.

Be particularly careful during installation and replacement of the battery. The manufacturer is not liable for the consequences of incorrect installation of the battery.

2.1 Tips for installation

- The button should be installed indoors, in spaces with normal air humidity.
- Do not install the button outdoors.
- When selecting a place of installation, consider the radio communication range.
- Thick walls, metal partitions, etc. reduce the range of the radio signal.
- Make sure you press down the double-sided mounting tape properly. First, stick the tape to the device and keep pressing for several seconds, then stick the device to the surface and keep pressing for several seconds.

2.2 Mounting

1. Open the button enclosure (Fig. 1).

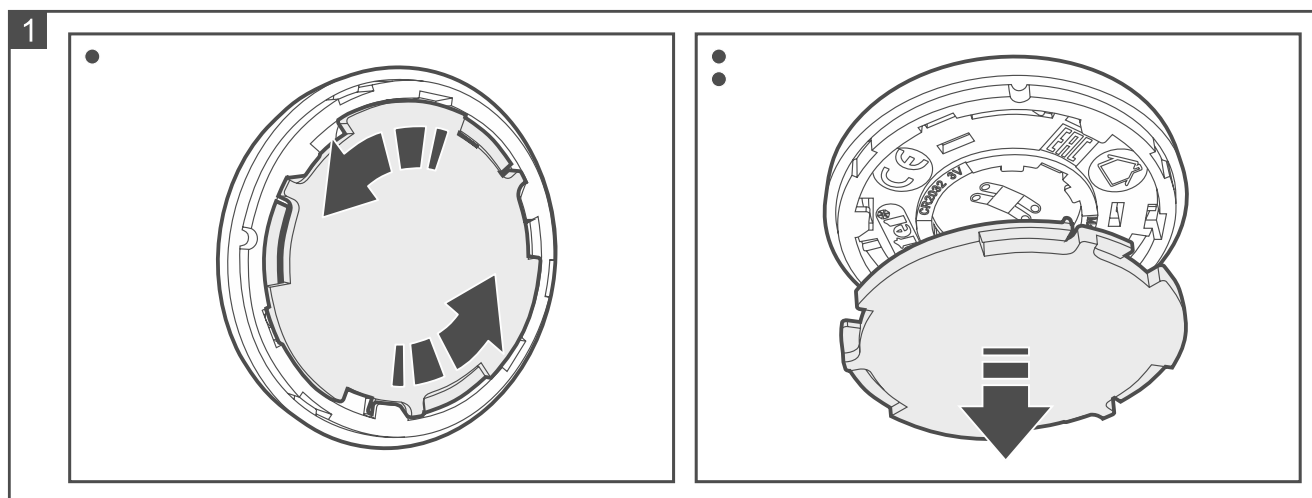

2. Stick the double-sided mounting tape to the enclosure base.
3. Stick the enclosure base to the surface.
4. Add the button to the system (see the manual for the BE WAVE system controller or the BE WAVE Hybrid system control panel). When a request to turn on the device will be displayed, install the battery in the button.
5. Close the button enclosure.

3. Battery replacement



The used batteries must not be discarded, but should be disposed of in accordance with the existing rules for environment protection.

The Be Wave app will indicate that the battery in the button is low. The low battery should be replaced as soon as possible.

1. In the Be Wave app / BE WAVE Soft program, tap / click the room in which the button is installed.
2. Tap / click the button name.
3. Start the *Battery replacement* function.
4. Open the button enclosure.
5. Remove the low battery.
6. Wait 1 minute.
7. Install the new battery.
8. Close the button enclosure.
9. Start the *Unbypass device* function in the Be Wave app / BE WAVE Soft program.

4. Specifications

Operating frequency band	868.0 MHz ÷ 868.6 MHz
Radio communication range (in open area)	up to 1300 m
Battery	CR2032 3 V
Battery life expectancy	up to 3 years
Standby current consumption	5 µA

Low battery voltage threshold	2.6 V
Environmental class according to EN 50130-5	II
Operating temperature range.....	-10°C...+55°C
Maximum humidity	93±3%
Dimensions	ø50 x 13 mm
Weight.....	17 g